

Appendix B

Engineer's Representative Instruction Letter



AECOM
8/F, Grand Central Plaza, Tower 2,
138 Shatin Rural Committee Road,
Shatin, Hong Kong
香港新界沙田鄉事會路 138 號
新城市中央廣場第 2 座 8 樓
www.aecom.com

PRE's Office
5 Ying Hei Road, Tung Chung
新界東涌迎禧路 5 號
Tel: 3958 7200
Fax: 3902 6800

Your Ref. :
Our Ref. : HKBCF/(VCP)/(HY/2013/03)/C15/450(0001)/B301226

16 October 2015

China Harbour Engineering Company Ltd.
19/F, China Harbour Building
370-374 King's Road
North Point
Hong Kong

Attn: Mr. Johnason Ko

Dear Sirs,

Contract No. HY/2013/03
Hong Kong-Zhuhai-Macao Bridge
Hong Kong Boundary Crossing Facilities –
Vehicle Clearance Plazas and Ancillary Buildings and Facilities

Arrangement for Disposal of Excavated Marine Mud

I refer to the recent discussions and at the Site Safety and Environmental Management Committee Meeting of 16 September 2015 regarding the arrangement for disposal of excavated Marine Mud.

I confirm that the treatment for Marine Mud excavated from the Works, including but not limited to the Pilot Scale Trials and subsequent Full Scale Cement Solidification / Stabilization process (PS Section C28 refers) are NOT required under the Contract at this stage. The commencement of the treatment process will be subject to further advice by the Engineer.

You are required to dispose the excavated Marine Mud generated under this Contract and from other contracts of the HZMB project on the HKBCF Island, at the designated disposal sites within Hong Kong as allocated by the Marine Fill Committee. The disposal shall be in compliance to conditions stipulated in the Environmental Permit No. EP-353/2009I and the subsequent version. You are also required to apply for Marine Dumping Permit for the marine disposal in accordance with ETWB TC(W) No. 34/2002 for the disposal of the excavated Marine Mud.

Please liaise with the contractor of Contract No. HY/2010/02, the HKBCF reclamation contract for using their existing floating barge for an agreed schedule and relevant facilities including the haul road leading to the barge at the HKBCF Island for disposal of the excavated Marine Mud. You are also required to receive the excavated Marine Mud generated from other contracts of the HZMB project and dispose. Please coordinate with these contracts and advise them the disposal schedule and haul road alignment.

Your Ref. :
Our Ref. : HKBCF/(VCP)/(HY/2013/03)/C15/450(000\)/B301226

A Variation Order covering the above changes will be issued separately.

Yours faithfully,
For and on behalf of
AECOM Asia Co. Ltd.



Michael Tovey
The Engineer's Representative
HKBCF VCP

MT/WSN/PKL/nmt

Your Ref. :
Our Ref. : HKBCF/(VCP)/(HY/2013/03)/C15/440()/B314281

8 May 2017

China Harbour Engineering Company Ltd.
19/F, China Harbour Building
370-374 King's Road
North Point
Hong Kong

Attn.: Mr. Johnason Ko

Dear Sirs,

Contract No. HY/2013/03
Hong Kong-Zhuhai-Macao Bridge
Hong Kong Boundary Crossing Facilities –
Vehicle Clearance Plazas and Ancillary Buildings and Facilities

Delivery of Public Fill

I refer to the recent discussions amongst HyD, CHEC and AECOM regarding the disposal of surplus public fill left behind by the HKBCF reclamation contract, which was tested and confirmed not suitable for the proposed landscaping works on site.

As designated by HyD, you are required to deliver the surplus fill material to reclamation area of HyD Contract No. HY/2012/08 – Tuen Mun – Chek Lap Kok Link – Northern Connection Sub-sea Tunnel Section at Tuen Mun as shown in the attached sketch no. SK/0001. The delivery shall be in compliance to conditions stipulated in the Environmental Permit No. EP-353/2009K and the subsequent version.

Please liaise with the contractor of Contract No. HY/2012/08 and unload the public fill in a coordinated manner.

A Variation Order covering the above work will be issued separately.

Yours faithfully,
For and on behalf of
AECOM Asia Co. Ltd.

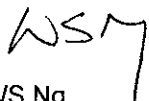

WS Ng
The Engineer's Representative
HKBCF VCP

Encl.

WSN/SL/ky

c.c. CE/HKBCF, HyD - Attn.: Mr. Ma Kuen
AECOM - Attn.: Mr. Bevis Mak

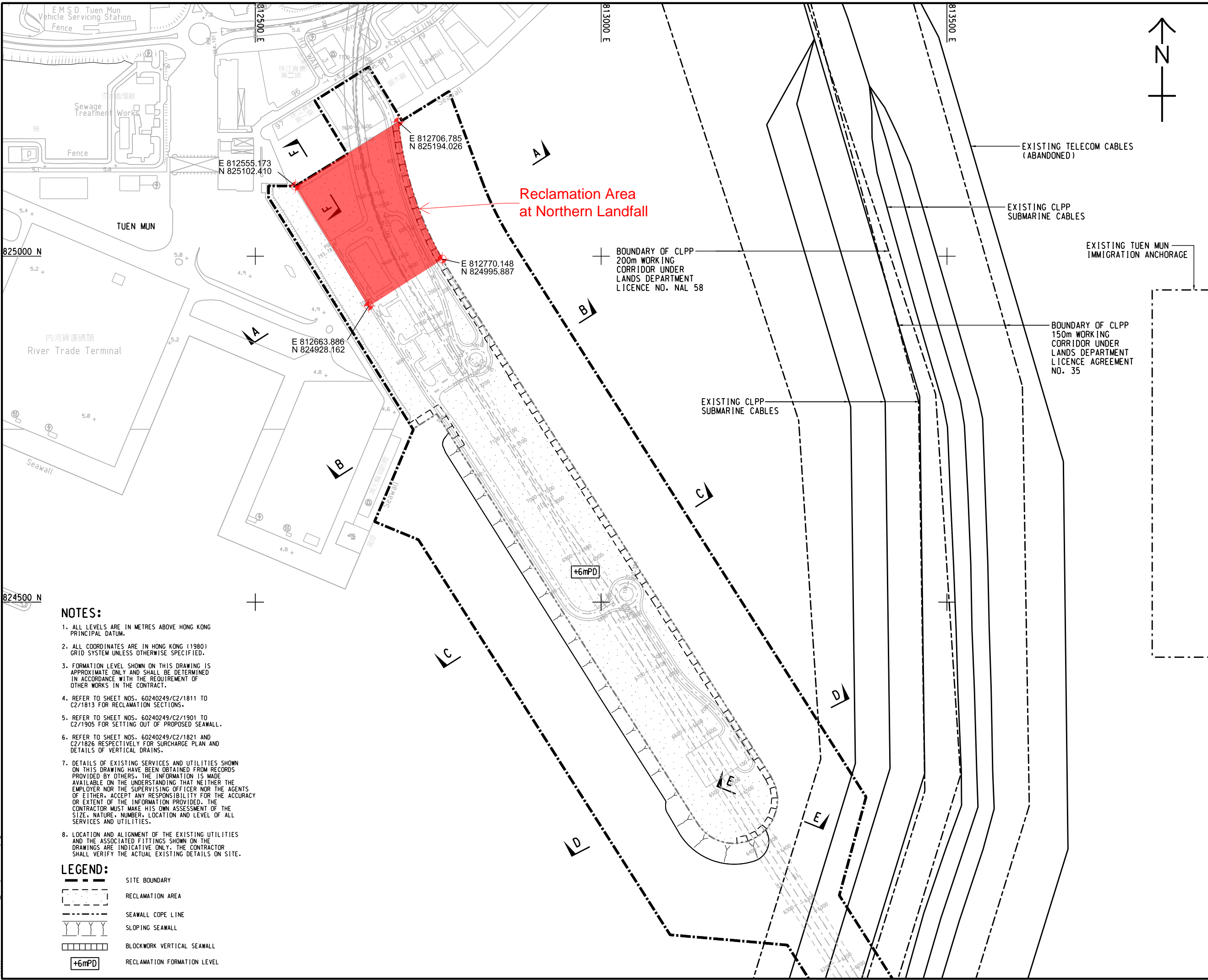

AECOM

PROJECT
 TUEN MUN - CHEK LAP KOK LINK

CONTRACT TITLE
 TUEN MUN - CHEK LAP KOK LINK - NORTHERN CONNECTION SUB-SEA TUNNEL SECTION

CLIENT

 路政署
 HIGHWAYS DEPARTMENT
 港務處大樓香港工程管理處
 Hong Kong - Zhuhai - Macao Bridge
 Hong Kong Project Management Office

CONSULTANT
 AECOM Asia Company Ltd.
 www.aecom.com

SUB-CONSULTANTS
 分判工程師公司

NOTES:

1. ALL LEVELS ARE IN METRES ABOVE HONG KONG PRINCIPAL DATUM.
2. ALL COORDINATES ARE IN HONG KONG (1980) GRID SYSTEM UNLESS OTHERWISE SPECIFIED.
3. FORMATION LEVEL SHOWN ON THIS DRAWING IS APPROXIMATE ONLY AND SHALL BE DETERMINED IN ACCORDANCE WITH THE REQUIREMENT OF OTHER WORKS IN THE CONTRACT.
4. REFER TO SHEET NOS. 60240249/C2/1811 TO C2/1813 FOR RECLAMATION SECTIONS.
5. REFER TO SHEET NOS. 60240249/C2/1901 TO C2/1905 FOR SETTING OUT OF PROPOSED SEAWALL.
6. REFER TO SHEET NOS. 60240249/C2/1821 AND C2/1826 RESPECTIVELY FOR SURCHARGE PLAN AND DETAILS OF VERTICAL DRAINS.
7. DETAILS OF EXISTING SERVICES AND UTILITIES SHOWN ON THIS DRAWING HAVE BEEN OBTAINED FROM RECORDS PROVIDED BY OTHERS. THE INFORMATION IS MADE AVAILABLE ON THE UNDERSTANDING THAT NEITHER THE EMPLOYER NOR THE SUPERVISING OFFICER NOR THE AGENTS OF EITHER, ACCEPT ANY RESPONSIBILITY FOR THE ACCURACY OR EXTENT OF THE INFORMATION PROVIDED. THE CONTRACTOR MUST MAKE HIS OWN ASSESSMENT OF THE SIZE, NATURE, NUMBER, LOCATION AND LEVEL OF ALL SERVICES AND UTILITIES.
8. LOCATION AND ALIGNMENT OF THE EXISTING UTILITIES AND THE ASSOCIATED FITTINGS SHOWN ON THE DRAWINGS ARE INDICATIVE ONLY. THE CONTRACTOR SHALL VERIFY THE ACTUAL EXISTING DETAILS ON SITE.

LEGEND:

- SITE BOUNDARY
- RECLAMATION AREA
- SEAWALL COPE LINE
- SLOPING SEAWALL
- BLOCKWORK VERTICAL SEAWALL
- RECLAMATION FORMATION LEVEL

I/R	DATE	DESCRIPTION	CHK.

STATUS
 WORKING DRAWING

SCALE **DIMENSION UNIT**
 A1 1 : 2500 METRES

KEY PLAN A1 1 : 100000

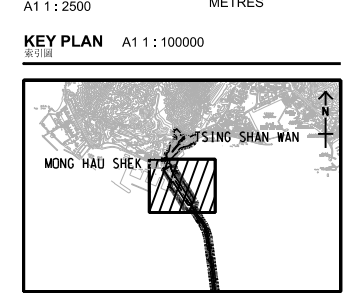

PROJECT NO. **CONTRACT NO.**
 60240249 HY/2012/08

SHEET TITLE
 RECLAMATION LAYOUT PLAN

SHEET NUMBER
 SK/0001

This drawing has been prepared for the use of AECOM's client. It may not be used, modified, reproduced or relied upon by third parties, except as agreed by AECOM or as required by law. AECOM accepts no responsibility, and declines any liability whatsoever, for any error, that arises or results from this drawing without AECOM's express written consent. All measurements must be obtained from the stated dimensions.