

# Master Landscape Plan (Level: G/F)

Hong Kong-Zhuhai-Macao Bridge  
Hong Kong Boundary Crossing Facilities (HKBCF) Superstructures and Infrastructures

For submission of Landscape and Visual Plan to EPD

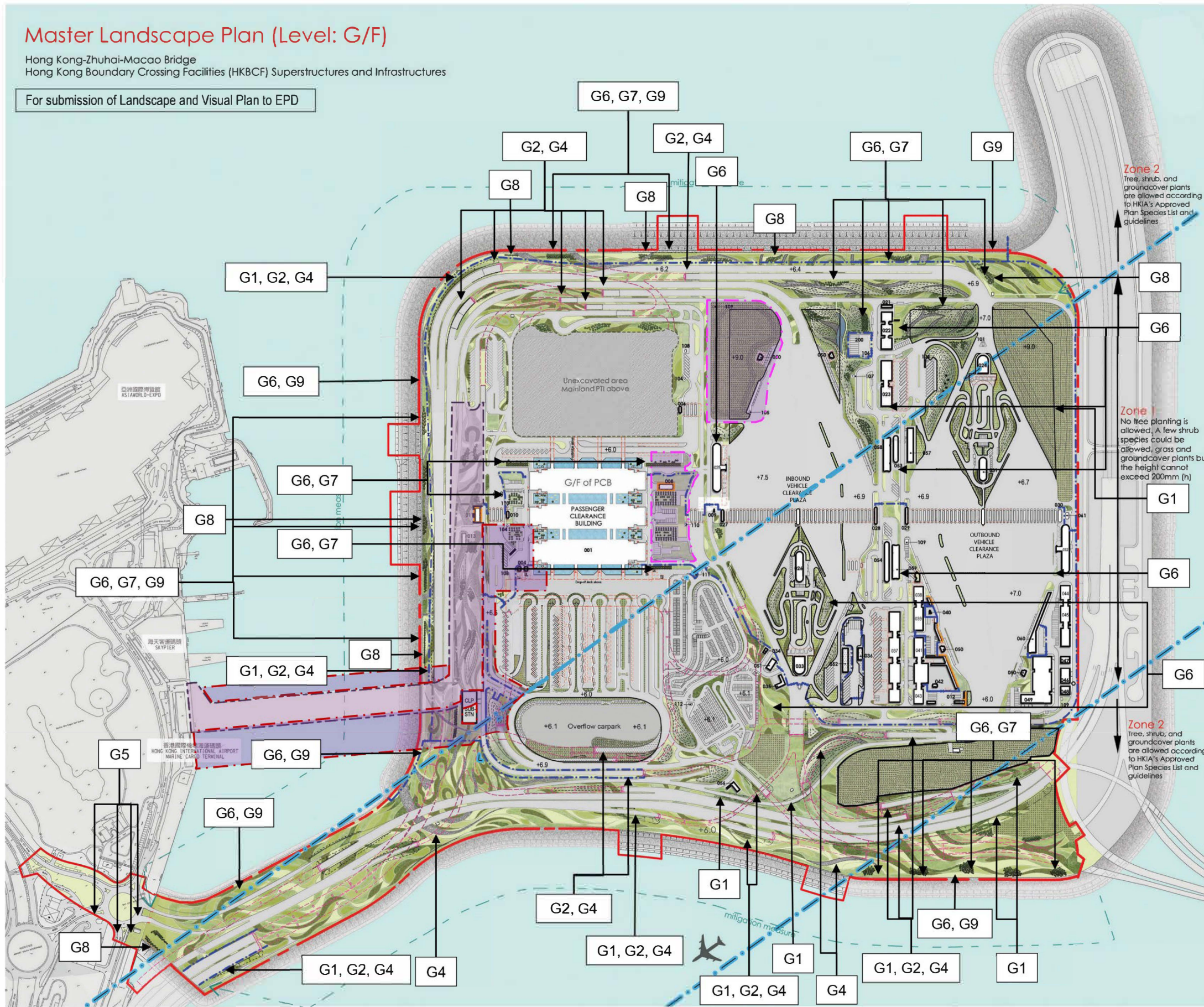

- LEGEND:**
- HKBCF site boundary
  - Elevated bridges with bridge pier/decks/ footbridges/ canopies
  - Boundary fence (1m maintenance path on both sides of fence)
  - Planting pattern formed by shrubs, groundcover & turves
  - Hydraseeding area
  - Multi-purpose areas (footpath/ at grade carriageway/ amenity area)
  - Multi-purpose areas with hard-paving (footpath/ at grade carriageway/ amenity area)
  - Green roof
  - Gentle landscape berm (not higher than 3m, slope gradient not larger than 14.5%)
  - Tree planting
  - Water features (around and inside PCB area)
  - Attenuation pond and bioswale
  - Stone swathe feature
  - Stone gravel finish (for future development)
  - Ancillary building
  - Vertical greening
  - SIMAR slope
  - Site boundary of "Intermodal Transfer Terminal - Bonded Vehicular Bridge and Associated Roads" provided by Permit Holder of Environmental Permit No. EP-560/2018. This area is covered in Environmental Permit No. EP-560/2018 and is excluded from the Environmental Permit of HKBCF Project No. EP-353/2009/K.
  - Site boundary of "Airport City Link" provided by Permit Holder of Environmental Permit No. EP-581/2020 and is excluded from the Environmental Permit of HKBCF Project No. EP-353/2009/K.
  - Site boundary of "HZMB HKBCF - Inbound Carpark A (Phase 1) and Inbound Carpark B (Phase 1)" provided by Permit Holder of Environmental Permit No. EP-02/553/2009/K. These carpark areas are covered in Environmental Permit No. EP-02/553/2009/K and are excluded from the Environmental Permit of HKBCF Project No. EP-353/2009/K.

**Building Number and Name**

001	PASSENGER CLEARANCE BUILDING
002	SKYPIER FOR BONDING PASSENGERS AND BONDING PUBLIC TOILET
003	REFUSE STORAGE AND MATERIAL RECOVERY CHAMBER
004	DEPARTURE COACH HUBS
005	ARRIVAL COACH HUBS
006	EMERGENCY GENERATOR ROOM
007	DMV DETECTION STATIONS
008	SEAWATER PUMP HOUSE
009	CRSD DANIELS SECURITY STORE
010	CRSD OUTBOUND DETECTOR ROOM (ONION ROAD DOGS BAY)
011	CRSD OUTBOUND PRIVATE CAR EXAMINATION BUILDING
012	ARRIVAL PRIVATE CAR EXAMINATION BUILDING
013	ARRIVAL PRIVATE CAR EXAMINATION CLEARANCE AREA
014	ARRIVAL PRIVATE CAR EXAMINATION CLEARANCE AREA
015	ARRIVAL PRIVATE CAR EXAMINATION CLEARANCE AREA
016	ARRIVAL PRIVATE CAR EXAMINATION CLEARANCE AREA
017	ARRIVAL PRIVATE CAR EXAMINATION CLEARANCE AREA
018	ARRIVAL PRIVATE CAR EXAMINATION CLEARANCE AREA
019	ARRIVAL PRIVATE CAR EXAMINATION CLEARANCE AREA
020	ARRIVAL PRIVATE CAR EXAMINATION CLEARANCE AREA
021	ARRIVAL PRIVATE CAR EXAMINATION CLEARANCE AREA
022	ARRIVAL PRIVATE CAR EXAMINATION CLEARANCE AREA
023	ARRIVAL PRIVATE CAR EXAMINATION CLEARANCE AREA
024	ARRIVAL PRIVATE CAR EXAMINATION CLEARANCE AREA
025	ARRIVAL PRIVATE CAR EXAMINATION CLEARANCE AREA
026	ARRIVAL PRIVATE CAR EXAMINATION CLEARANCE AREA
027	ARRIVAL PRIVATE CAR EXAMINATION CLEARANCE AREA
028	ARRIVAL PRIVATE CAR EXAMINATION CLEARANCE AREA
029	ARRIVAL PRIVATE CAR EXAMINATION CLEARANCE AREA
030	ARRIVAL PRIVATE CAR EXAMINATION CLEARANCE AREA
031	ARRIVAL PRIVATE CAR EXAMINATION CLEARANCE AREA
032	ARRIVAL PRIVATE CAR EXAMINATION CLEARANCE AREA
033	ARRIVAL PRIVATE CAR EXAMINATION CLEARANCE AREA
034	ARRIVAL PRIVATE CAR EXAMINATION CLEARANCE AREA
035	ARRIVAL PRIVATE CAR EXAMINATION CLEARANCE AREA
036	ARRIVAL PRIVATE CAR EXAMINATION CLEARANCE AREA
037	ARRIVAL PRIVATE CAR EXAMINATION CLEARANCE AREA
038	ARRIVAL PRIVATE CAR EXAMINATION CLEARANCE AREA
039	ARRIVAL PRIVATE CAR EXAMINATION CLEARANCE AREA
040	ARRIVAL PRIVATE CAR EXAMINATION CLEARANCE AREA
041	ARRIVAL PRIVATE CAR EXAMINATION CLEARANCE AREA
042	ARRIVAL PRIVATE CAR EXAMINATION CLEARANCE AREA
043	ARRIVAL PRIVATE CAR EXAMINATION CLEARANCE AREA
044	ARRIVAL PRIVATE CAR EXAMINATION CLEARANCE AREA
045	ARRIVAL PRIVATE CAR EXAMINATION CLEARANCE AREA
046	ARRIVAL PRIVATE CAR EXAMINATION CLEARANCE AREA
047	ARRIVAL PRIVATE CAR EXAMINATION CLEARANCE AREA
048	ARRIVAL PRIVATE CAR EXAMINATION CLEARANCE AREA
049	ARRIVAL PRIVATE CAR EXAMINATION CLEARANCE AREA
050	ARRIVAL PRIVATE CAR EXAMINATION CLEARANCE AREA
051	ARRIVAL PRIVATE CAR EXAMINATION CLEARANCE AREA
052	ARRIVAL PRIVATE CAR EXAMINATION CLEARANCE AREA
053	ARRIVAL PRIVATE CAR EXAMINATION CLEARANCE AREA
054	ARRIVAL PRIVATE CAR EXAMINATION CLEARANCE AREA
055	ARRIVAL PRIVATE CAR EXAMINATION CLEARANCE AREA
056	ARRIVAL PRIVATE CAR EXAMINATION CLEARANCE AREA
057	ARRIVAL PRIVATE CAR EXAMINATION CLEARANCE AREA
058	ARRIVAL PRIVATE CAR EXAMINATION CLEARANCE AREA
059	ARRIVAL PRIVATE CAR EXAMINATION CLEARANCE AREA
060	ARRIVAL PRIVATE CAR EXAMINATION CLEARANCE AREA
061	ARRIVAL PRIVATE CAR EXAMINATION CLEARANCE AREA
062	ARRIVAL PRIVATE CAR EXAMINATION CLEARANCE AREA
063	ARRIVAL PRIVATE CAR EXAMINATION CLEARANCE AREA
064	ARRIVAL PRIVATE CAR EXAMINATION CLEARANCE AREA
065	ARRIVAL PRIVATE CAR EXAMINATION CLEARANCE AREA
066	ARRIVAL PRIVATE CAR EXAMINATION CLEARANCE AREA
067	ARRIVAL PRIVATE CAR EXAMINATION CLEARANCE AREA
068	ARRIVAL PRIVATE CAR EXAMINATION CLEARANCE AREA
069	ARRIVAL PRIVATE CAR EXAMINATION CLEARANCE AREA
070	ARRIVAL PRIVATE CAR EXAMINATION CLEARANCE AREA
071	ARRIVAL PRIVATE CAR EXAMINATION CLEARANCE AREA
072	ARRIVAL PRIVATE CAR EXAMINATION CLEARANCE AREA
073	ARRIVAL PRIVATE CAR EXAMINATION CLEARANCE AREA
074	ARRIVAL PRIVATE CAR EXAMINATION CLEARANCE AREA
075	ARRIVAL PRIVATE CAR EXAMINATION CLEARANCE AREA
076	ARRIVAL PRIVATE CAR EXAMINATION CLEARANCE AREA
077	ARRIVAL PRIVATE CAR EXAMINATION CLEARANCE AREA
078	ARRIVAL PRIVATE CAR EXAMINATION CLEARANCE AREA
079	ARRIVAL PRIVATE CAR EXAMINATION CLEARANCE AREA
080	ARRIVAL PRIVATE CAR EXAMINATION CLEARANCE AREA
081	ARRIVAL PRIVATE CAR EXAMINATION CLEARANCE AREA
082	ARRIVAL PRIVATE CAR EXAMINATION CLEARANCE AREA
083	ARRIVAL PRIVATE CAR EXAMINATION CLEARANCE AREA
084	ARRIVAL PRIVATE CAR EXAMINATION CLEARANCE AREA
085	ARRIVAL PRIVATE CAR EXAMINATION CLEARANCE AREA
086	ARRIVAL PRIVATE CAR EXAMINATION CLEARANCE AREA
087	ARRIVAL PRIVATE CAR EXAMINATION CLEARANCE AREA
088	ARRIVAL PRIVATE CAR EXAMINATION CLEARANCE AREA
089	ARRIVAL PRIVATE CAR EXAMINATION CLEARANCE AREA
090	ARRIVAL PRIVATE CAR EXAMINATION CLEARANCE AREA
091	ARRIVAL PRIVATE CAR EXAMINATION CLEARANCE AREA
092	ARRIVAL PRIVATE CAR EXAMINATION CLEARANCE AREA
093	ARRIVAL PRIVATE CAR EXAMINATION CLEARANCE AREA
094	ARRIVAL PRIVATE CAR EXAMINATION CLEARANCE AREA
095	ARRIVAL PRIVATE CAR EXAMINATION CLEARANCE AREA
096	ARRIVAL PRIVATE CAR EXAMINATION CLEARANCE AREA
097	ARRIVAL PRIVATE CAR EXAMINATION CLEARANCE AREA
098	ARRIVAL PRIVATE CAR EXAMINATION CLEARANCE AREA
099	ARRIVAL PRIVATE CAR EXAMINATION CLEARANCE AREA
100	ARRIVAL PRIVATE CAR EXAMINATION CLEARANCE AREA



AGREEMENT NO. CE 13/2010 (CE)  
HONG KONG-ZHUHAI-MACAO BRIDGE HONG KONG BOUNDARY CROSSING FACILITIES (SUPERSTRUCTURES AND INFRASTRUCTURES) DESIGN AND CONSTRUCTION  
MASTER LANDSCAPE PLAN (LEVEL: GROUND LEVEL)

SCALE	N.T.S.	DATE	10 MARCH 2022
FIGURE NO.	FIGURE 3.1a (rev.A)		