

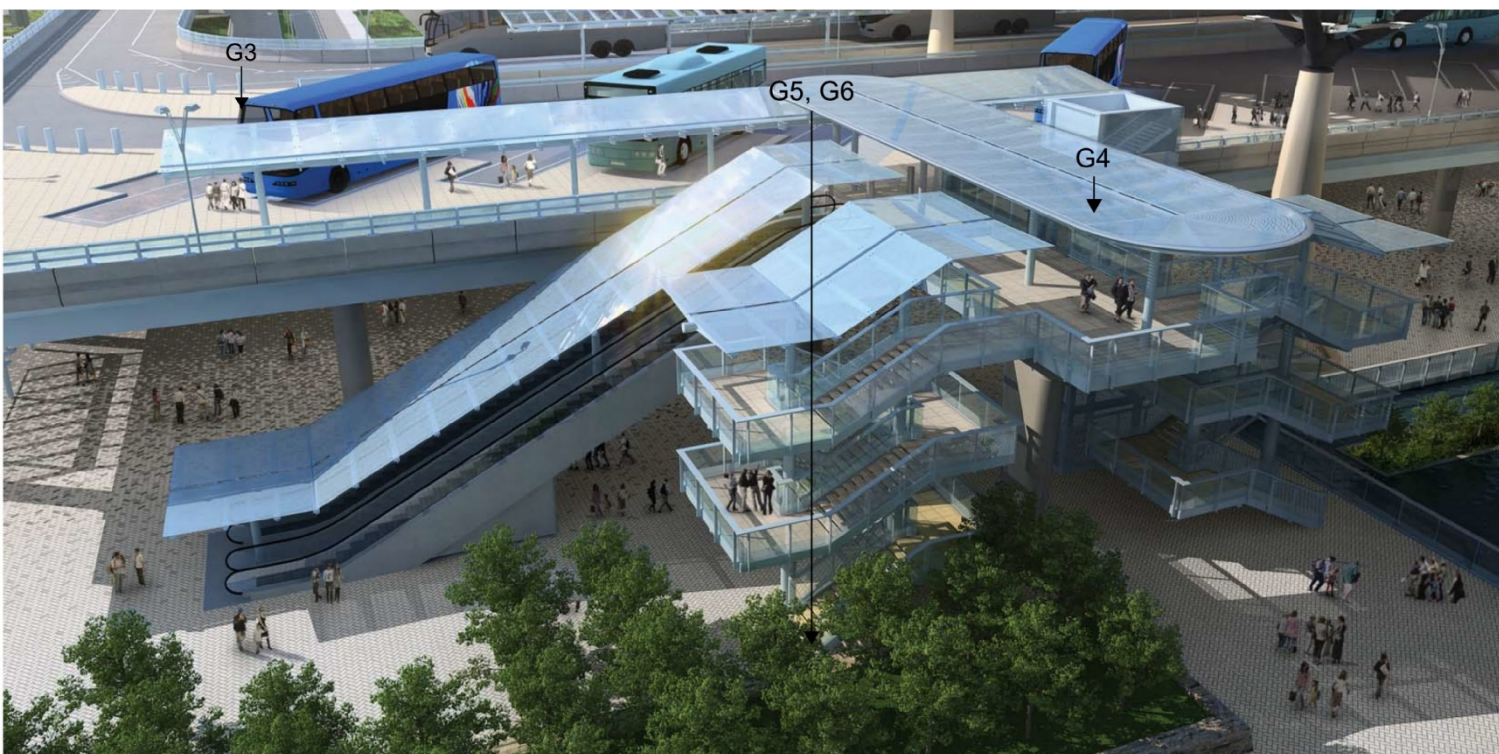

Footbridges at PCB (Interface Detail) (North)

Note: Reference to ACABAS Submission - PCB Main Roof / PTI Canopy (Ref. 173-01)

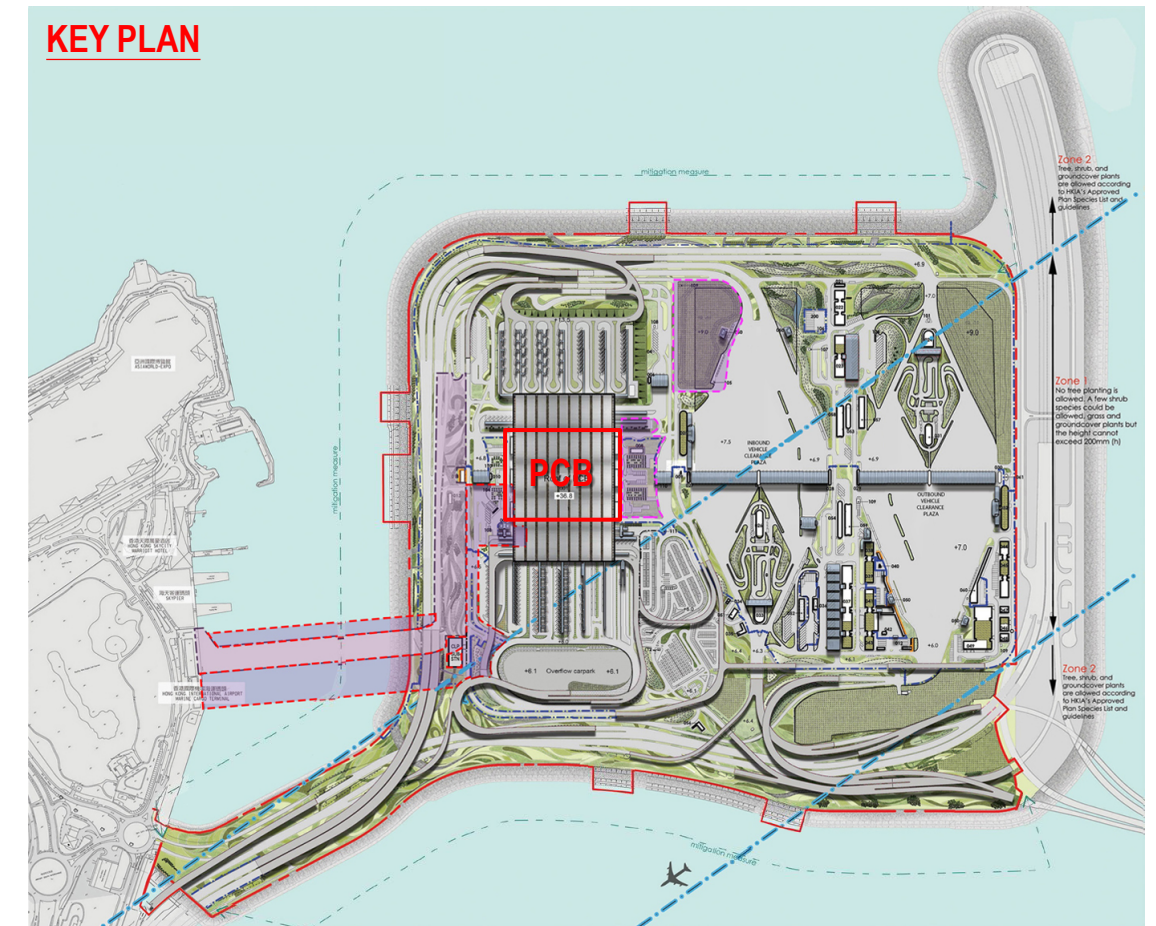

Vertical Circulation  
East Core - View from North East

Note: Reference to Landscape Proposal for HKBCF (Ref. 181-02)

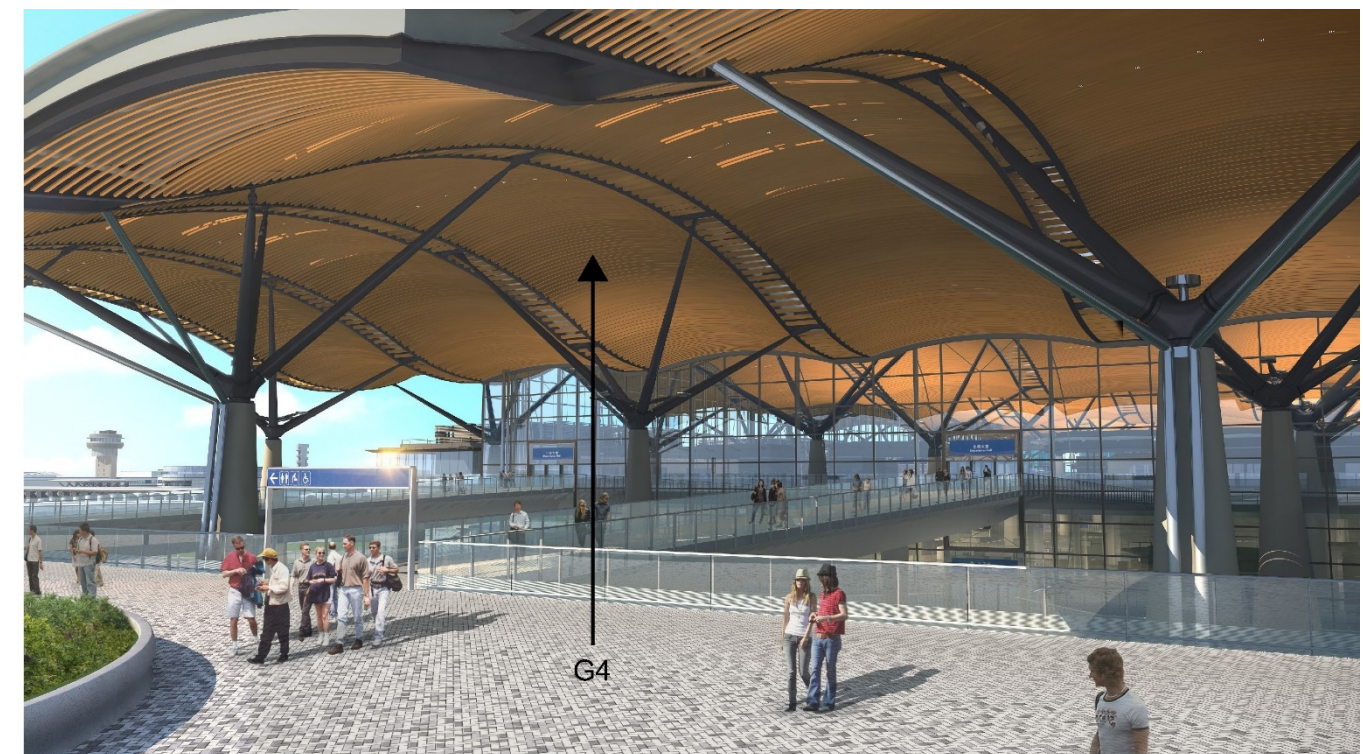

Footbridges at PCB (North)

Note: Reference to ACABAS Submission - PCB Main Roof / PTI Canopy (Ref. 173-01)