

## **MATERIALAB CONSULTANTS LIMITED**

Room 723 & 725, 7/F, Block B,  
Profit Industrial Building,  
1-15 Kwai Fung Crescent, Kwai Fong,  
Hong Kong.

Tel : (852)-24508238  
Fax : (852)-24508032  
Email : mcl@fugro.com

---

**MaterialLab**

---

Report No.: 0165/15/ED/0820

---

### **Appendix A**

#### **Location of Works Areas**



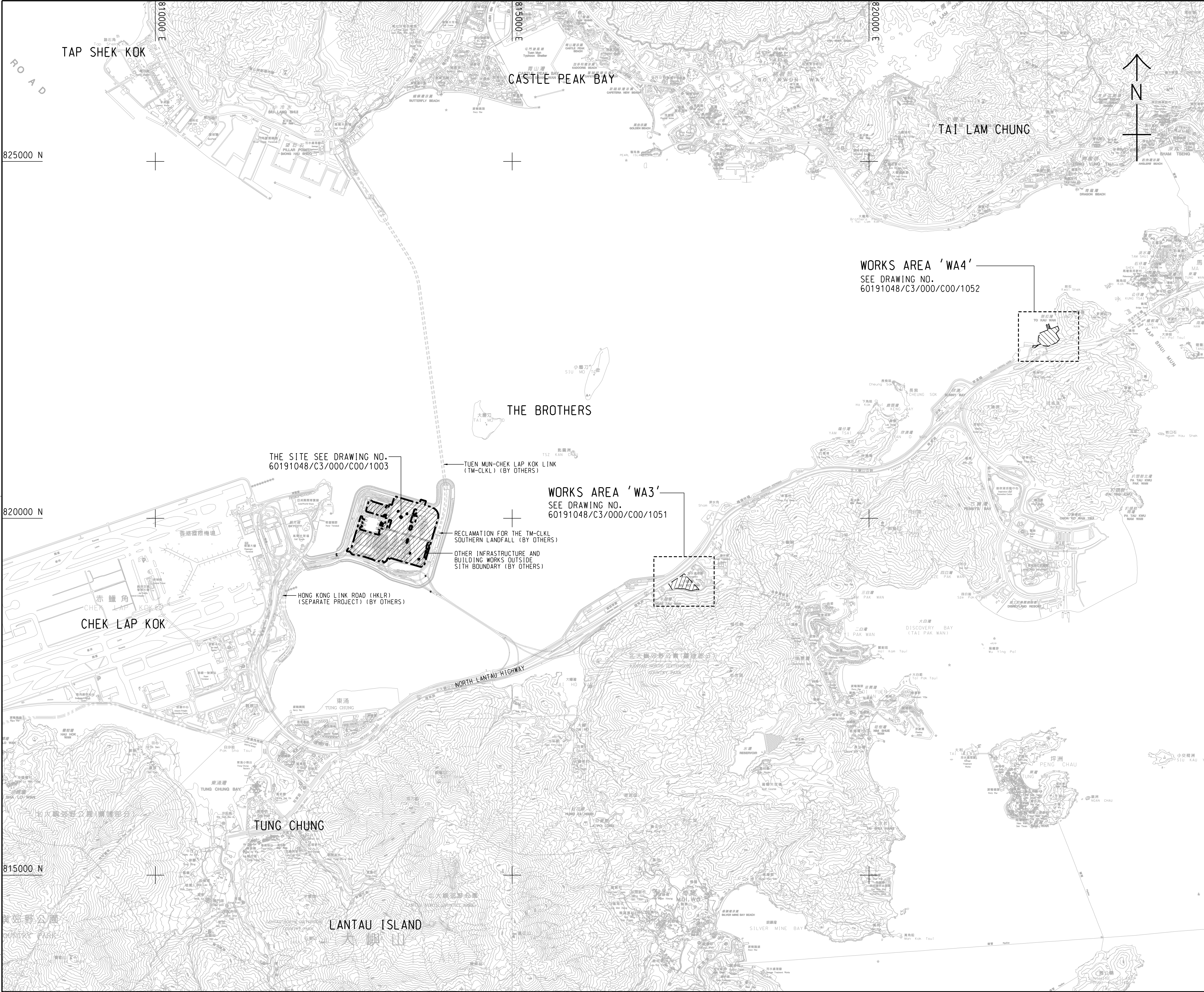

NOTES:

- COORDINATES ARE RELATED TO HONG KONG METRIC GRID (1980).
- DIMENSIONS ARE IN MILLIMETER AND CHAINAGE ARE IN METRES UNLESS OTHERWISE SHOWN.
- THIS DRAWING SHALL BE READ IN CONJUNCTION WITH DRAWING NOS. 60191048/C3/000/C00/1051 TO 1053.

LEGEND:

- SITE BOUNDARY
- WORKS AREA

|                  |                   |          |          |
|------------------|-------------------|----------|----------|
| - TENDER DRAWING |                   | BWCW SCI | MAR. 14  |
| REV.             | DESCRIPTION       | DATE     | DATE     |
| 01               | ISSUED FOR TENDER | 01/03/14 | 01/03/14 |

**HIGHWAYS DEPARTMENT**  
路政署  
香港大橋工程管理局  
Hong Kong - Zhuhai - Macao Bridge Hong Kong Project Management Office  
HONG KONG-ZHUHAI-MACAO BRIDGE  
HONG KONG BOUNDARY CROSSING FACILITIES  
VEHICLE CLEARANCE PLAZAS AND  
ANCILLARY BUILDINGS AND FACILITIES

SITE LOCATION PLAN

|                                  |              |                      |                         |
|----------------------------------|--------------|----------------------|-------------------------|
| <b>AECOM</b>                     |              | <b>Aedas</b>         |                         |
| Rogers Stirk Harbour + Partners  |              |                      |                         |
| BURO HAPPOLD                     | ATKINS       | ADI                  |                         |
|                                  |              |                      |                         |
| DRG.NO. 60191048/C3/000/C00/1000 |              |                      |                         |
| 圖紙編號                             |              |                      |                         |
| DESIGNED BY<br>設計                | BWCW         | CONTRACT NO.<br>合約編號 | P. Dir. APPROVED<br>批准人 |
|                                  |              | HY/2013/03           | TKH <i>WT</i>           |
| DRAWN BY<br>繪圖                   | WSY          | STATUS<br>階段         |                         |
| SCALE<br>比例                      | A1 1 : 25000 |                      |                         |
| DIMENSIONS ARE IN<br>尺寸單位        |              | COPYRIGHT RESERVED   |                         |
| METRES                           |              | 版 權 所 有              |                         |



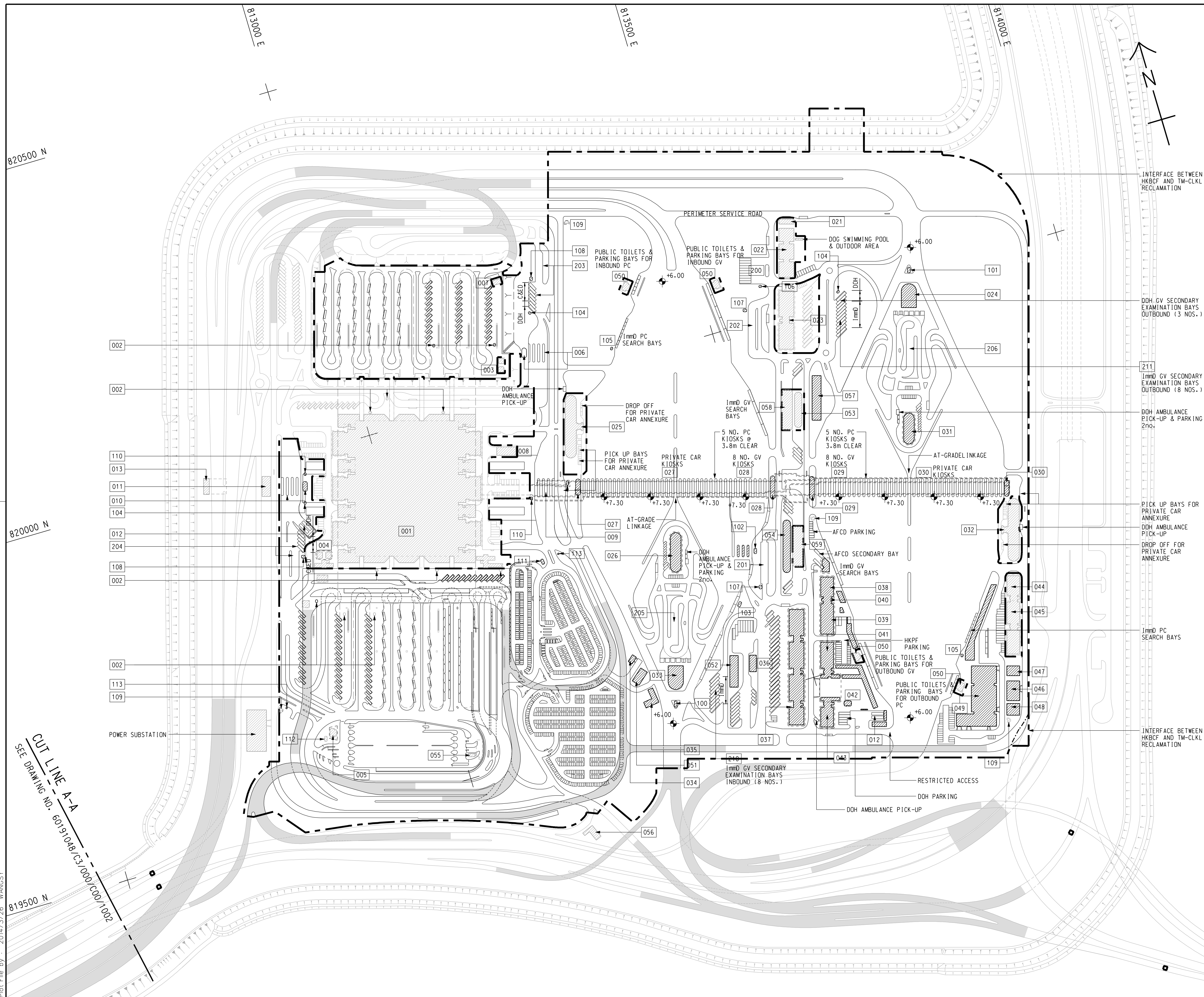



NOTE:

1. THIS DRAWING TO BE READ IN CONJUNCTION WITH  
DRAWING NO. 60191048/C3/000/C00/1003.

LEGEND:

- |   |                     |
|---|---------------------|
|  | SITE BOUNDARY       |
|  | VIADUCT             |
|  | BUILDING/FACILITIES |

# INTERFACE BETWEEN HKBCF AND TM-CLKL RECLAMATION

DDH\_GV SECONDARY  
EXAMINATION BAYS  
OUTBOUND (3 NOS.)

Immd GV SECONDARY  
EXAMINATION BAYS  
OUTBOUND (8 NOS.)

DOH AMBULANCE  
PICK-UP & PARKING  
2no.

PICK UP BAYS FOR  
PRIVATE CAR  
ANNEXURE  
DOH AMBULANCE  
PICK-UP  
DROP OFF FOR  
PRIVATE CAR  
ANNEXURE

ImmD PC  
SEARCH BAYS

# INTERFACE BETWEEN HKBCF AND TM-CLKL RECLAMATION

|   |                |          |         |
|---|----------------|----------|---------|
| - | TENDER DRAWING | BWCW SCI | MAR. 14 |
|---|----------------|----------|---------|

 **路政署**  
**HIGHWAYS DEPARTMENT**

 **港珠澳大橋香港工程管理處**  
**Hong Kong - Zhuhai - Macao Bridge Hong Kong Project Management Office**

HONG KONG-ZHUHAI-MACAO BRIDGE  
HONG KONG BOUNDARY CROSSING FACILITIES  
- VEHICLE CLEARANCE PLAZAS AND  
ANCILLARY BUILDINGS AND FACILITIES

**Figure 1- 1  
Current Layout Plan**

SHEET 1 OF 2

|                                 |   |       |
|---------------------------------|---|-------|
| <b>AECOM</b>                    | + | +     |
| Rogers Stirk Harbour + Partners |   |       |
| BURO HAPPOLD   ATKINS   ADI     | + | +     |
|                                 |   | Aedas |

DRG.NO. 60191048/C3/000/C00/1001  
圖紙編號

|                           |             |                                |                         |    |
|---------------------------|-------------|--------------------------------|-------------------------|----|
| DESIGNED BY<br>設計         | BWCW        | CONTRACT NO.<br>合約編號           | P. Dir. APPROVED<br>批准人 | WT |
| DRAWN BY<br>繪圖            | WSY         | STATUS<br>階段                   | TKH                     |    |
| SCALE<br>比例               | A1 1 : 2500 |                                |                         |    |
| DIMENSIONS ARE IN<br>尺寸單位 | METRES      | © COPYRIGHT RESERVED<br>版權 所 有 |                         |    |







## SETTING OUT POINT



822400 N

Plot File by: 2014/5/5 WANGSY

P:\PROJECTS\60191048\DRAWING\CONTRACT\C3\1000\C3\_000\_C00\_1052.dgn

KAP S  
M

**SUNNY BAY**

TSO WAN

LOCATION PLAN

SCALE 1 : 25000

1. COORDINATES ARE RELATED TO HONG KONG METRIC GRID (1980).
2. DIMENSIONS ARE IN MILLIMETER AND CHAINAGE ARE IN METRES UNLESS OTHERWISE SHOWN.

| WORKS AREA BOUNDARY |             |
|---------------------|-------------|
|                     | PORTION 4.1 |
|                     | PORTION 4.2 |
|                     | PORTION 4.3 |
|                     | PORTION 4.4 |
|                     | PORTION 4.5 |
|                     | PORTION 4.6 |
|                     | PORTION 4.7 |
|                     | PORTION 4.8 |
|                     | PORTION 4.9 |

CONTROLLED  
DOCUMENT

不准未許可

**FOR CONSTRUCTION**

|         |                       |         |      |         |
|---------|-----------------------|---------|------|---------|
| C       | WORKING DRAWING       | BWC     | SCI  | MAY. 15 |
| B       | TENDER ADDENDUM NO. 2 | BWC     | SCI  | MAY. 14 |
| A       | TENDER ADDENDUM NO. 1 | BWC     | SCI  | APR. 14 |
| -       | TENDER DRAWING        | BWC     | SCI  | MAR. 14 |
| REV. #1 | DESCRIPTION           | REV. #1 | DATE |         |



HONG KONG-ZHUHAI-MACAO BRIDGE  
HONG KONG BOUNDARY CROSSING FACILITIES  
- VEHICLE CLEARANCE PLAZAS AND  
ANCILLARY BUILDINGS AND FACILITIES

WORKS AREA WA4



## Aedas

**Rogers Stirk Harbour + Partners**  
**BURO HAPPOLD    ATKINS    ADI**

DRGNO. 60191048/C3/000/C00/1052C

|                           |               |                              |                 |                           |     |    |
|---------------------------|---------------|------------------------------|-----------------|---------------------------|-----|----|
| DESIGNED BY<br>設計人        | BWCW          | CONTRACT NO.<br>合約編號         | HY/2013/03      | P. Dir. - APPROVED<br>負責人 | TKH | WT |
| DRAWN BY<br>繪圖人           | WSY           | STATES<br>用途                 | WORKING DRAWING |                           |     |    |
| SCALE<br>比例               | A1 : 1 : 1000 |                              |                 |                           |     |    |
| DIMENSIONS ARE IN<br>尺寸單位 | METRES        | © COPYRIGHT RESERVED<br>版權所有 |                 |                           |     |    |